

## Farm Data Sheets

For: Char-Ver Inc.

17.62 +/- Acres in Winnebago County

- Winnebago County Assessor Page
  - USDA Aerial Map (Note: Includes land that has been sold with the acreage).
  - USDA 156 Farm Record (Note: Includes land that has been sold with the acreage).
  - Surety Soil Map (Note: Includes land that has been sold with the acreage).
  - Conservation Plan
  - Winnebago County GIS Map
- 

# Winnebago County, IA

## Summary

**Parcel ID** 0508400005  
**Alternate ID**  
**Property Address** N/A  
**Sec/Twp/Rng** N/A  
**Brief Tax Description** 08 99 26 PART OF N1/2 SE 1/4 8 99 26 LYING N & E OF DD EX THE E 499.2' OF N 480'  
(Note: Not to be used on legal documents.)  
**Deed Book/Page** 04-0055 (1/6/2004)  
**Contract Book/Page**  
**Gross Acres** 17.62  
**Net Acres** 17.62  
**Class** A - Agriculture  
(Note: This is for tax purposes only. Not to be used for zoning.)  
**District** BUNI - BUFFALO TWP/NORTH IOWA SCH/  
**School District** NORTH IOWA SCHOOL

## Owner

**Deed Holder**  
 Char Ver Inc  
 12530 Dorchester Trl  
 St Paul MN 55124-5240  
**Contract Holder**  
**Mailing Address**  
 Char Ver Inc  
 12530 Dorchester Trl  
 St Paul MN 55124-5240

## Land

**Lot Area** 17.62 Acres :767,527 SF

## Sales (After/On 1/1/2005)

Date	Seller	Buyer	Recording	Type	Remarks	Amount
1/6/2004	MYERS BRUCE E &	CHAR-VER INC	04-0055	Normal Arms-Length Transaction		\$39,000.00

## Sales (Before 1/1/2005)

Date	Seller	Buyer	Recording	Type	Amount
1/6/2004	Myers Bruce E &	Char-Ver Inc	04/0055	Normal Arms-Length Transaction	\$39,000.00

## Valuation

Classification	2023	2022	2021	2020	2019
	Agriculture	Agriculture	Agriculture	Agriculture	Agriculture
+ Assessed Land Value	\$32,392	\$25,311	\$25,311	\$26,928	\$26,928
+ Assessed Building Value	\$0	\$0	\$0	\$0	\$0
+ Assessed Dwelling Value	\$0	\$0	\$0	\$0	\$0
= <b>Gross Assessed Value</b>	<b>\$32,392</b>	<b>\$25,311</b>	<b>\$25,311</b>	<b>\$26,928</b>	<b>\$26,928</b>
- Exempt Value	\$0	\$0	\$0	\$0	\$0
= <b>Net Assessed Value</b>	<b>\$32,392</b>	<b>\$25,311</b>	<b>\$25,311</b>	<b>\$26,928</b>	<b>\$26,928</b>

## Taxation

	2022	2021	2020	2019
	Pay 2023-2024	Pay 2022-2023	Pay 2021-2022	Pay 2020-2021
+ Taxable Land Value	\$23,196	\$22,537	\$22,628	\$21,942
+ Taxable Building Value	\$0	\$0	\$0	\$0
+ Taxable Dwelling Value	\$0	\$0	\$0	\$0
= <b>Gross Taxable Value</b>	<b>\$23,196</b>	<b>\$22,537</b>	<b>\$22,628</b>	<b>\$21,942</b>
- Military Exemption	\$0	\$0	\$0	\$0
= <b>Net Taxable Value</b>	<b>\$23,196</b>	<b>\$22,537</b>	<b>\$22,628</b>	<b>\$21,942</b>
x Levy Rate (per \$1000 of value)	27.97556	25.15535	25.90517	25.93618
= <b>Gross Taxes Due</b>	<b>\$648.92</b>	<b>\$566.93</b>	<b>\$586.18</b>	<b>\$569.09</b>
- Ag Land Credit	(\$10.14)	(\$12.14)	(\$10.92)	(\$8.64)
- Family Farm Credit	(\$7.22)	(\$8.60)	(\$7.72)	(\$6.06)
- Homestead Credit	\$0.00	\$0.00	\$0.00	\$0.00
- Disabled and Senior Citizens Credit	\$0.00	\$0.00	\$0.00	\$0.00
- Business Property Credit	\$0.00	\$0.00	\$0.00	\$0.00

	2022	2021	2020	2019
	Pay 2023-2024	Pay 2022-2023	Pay 2021-2022	Pay 2020-2021
= Net Taxes Due	\$632.00	\$546.00	\$568.00	\$554.00

### Tax History

If applicable, See below for Drainage and Special Assessments

Year	Due Date	Amount	Paid	Date Paid	Receipt
2022	March 2024	\$316	No		
	September 2023	\$316	Yes	10/2/2023	093879
2021	March 2023	\$273	Yes	3/27/2023	
	September 2022	\$273	Yes	9/22/2022	081298
2020	March 2022	\$284	Yes	3/16/2022	
	September 2021	\$284	Yes	10/8/2021	070811

### Drainage and Special Assessments

Project:  
2022 - DD 6 - REPAIRS

Accepted Date:  
7/19/2022

Parcel Number:  
0508400005

Name:  
CHAR VER INC

Amortization Date:  
12/1/2022

Amortized Interest:  
0

Number of Years:  
0

Payoff:  
\$0.00

Payment	Due Date	Principal Left	Tax Billed	Amortized Interest	Interest	Admin Fees	Total	Receipt Number	Date Paid
1	9/30/2022	\$58.07	\$58.07	\$0.00	\$0.00	\$5.00	\$63.07	R00161332	9/22/2022
<b>Total</b>			\$58.07	\$0.00	\$0.00	\$5.00	\$63.07		

Project:  
2018-6 - SPRAYING

Accepted Date:  
7/17/2018

Parcel Number:  
0508400005

Name:  
CHAR VER INC

Amortization Date:  
12/1/2018

Amortized Interest:  
0

Number of Years:  
0

Payoff:  
\$0.00

Payment	Due Date	Principal Left	Tax Billed	Amortized Interest	Interest	Admin Fees	Total	Receipt Number	Date Paid
1	9/30/2018	\$5.00	\$5.00	\$0.00	\$0.00	\$5.00	\$10.00	R00063793	9/12/2018
<b>Total</b>			\$5.00	\$0.00	\$0.00	\$5.00	\$10.00		

**Project:**  
 20151001 D D 6 - 20151001 D D 6  
**Accepted Date:**  
 10/1/2015  
**Parcel Number:**  
 0508400005  
**Name:**  
 CHAR VER INC  
**Amortization Date:**  
 12/1/2015  
**Amortized Interest:**  
 0  
**Number of Years:**  
 0  
**Payoff:**  
 \$0.00

Payment ▾	Due Date ⇅	Principal Left ⇅	Tax Billed ⇅	Amortized Interest ⇅	Interest ⇅	Admin Fees ⇅	Total ⇅	Receipt Number	Date Paid ⇅
1	9/30/2015	\$6.18	\$6.18	\$0.00	\$1.00	\$3.00	\$10.18		11/23/2015
<b>Total</b>			<b>\$6.18</b>	<b>\$0.00</b>	<b>\$1.00</b>	<b>\$3.00</b>	<b>\$10.18</b>		

## Iowa Land Records

(04-0055)

Data for Winnebago County between Beacon and Iowa Land Records is available on the Iowa Land Records site beginning in 1999.  
 For records prior to 1999, contact the County Recorder or Customer Support at [www.iowaLandRecords.org](http://www.iowaLandRecords.org).

**No data available for the following modules:** Doing Business As, Residential Dwellings, Commercial Buildings, Agricultural Buildings, Yard Extras, Permits, Tax Sale Certificates, Photos, Sketches.

The information in this web site represents current data from a working file which is updated continuously. Information is believed reliable, but its accuracy cannot be guaranteed.  
[User Privacy Policy](#) | [GDPR Privacy Notice](#)  
 Last Data Upload: 2/5/2024, 1:01:52 AM

[Contact Us](#)

Developed by  

**Schneider**  
 GEOSPATIAL



- Legend**
- Non-Cropland
  - Cropland
  - CRP
  - Tract Boundary
  - Iowa PLSS
  - Iowa Roads

- Wetland Determination Identifiers**
- Restricted Use
  - ▼ Limited Restrictions
  - Exempt from Conservation Compliance Provisions

Tract Cropland Total: 19.89 acres

2023 Program Year  
Map Created May 05, 2023

**Farm 4934**  
**Tract 4343**

United States Department of Agriculture (USDA) Farm Service Agency (FSA) maps are for FSA Program administration only. This map does not represent a legal survey or reflect actual ownership; rather it depicts the information provided directly from the producer and/or National Agricultural Imagery Program (NAIP) imagery. The producer accepts the data 'as is' and assumes all risks associated with its use. USDA-FSA assumes no responsibility for actual or consequential damage incurred as a result of any user's reliance on this data outside FSA Programs. Wetland identifiers do not represent the size, shape, or specific determination of the area. Refer to your original determination (CPA-026 and attached maps) for exact boundaries and determinations or contact USDA Natural Resources Conservation Service (NRCS).

USDA is an equal opportunity provider, employer, and lender.



**Abbreviated 156 Farm Record**

Operator Name :  
 CRP Contract Number(s) : None  
 Recon ID : None  
 Transferred From : None  
 ARCPLC G//F Eligibility : Eligible

**Farm Land Data**

Farmland	Cropland	DCP Cropland	WBP	EWP	WRP	GRP	Sugarcane	Farm Status	Number Of Tracts
24.22	19.90	19.90	0.00	0.00	0.00	0.00	0.0	Active	1
State Conservation	Other Conservation	Effective DCP Cropland	Double Cropped		CRP	MPL	DCP Ag.Rel. Activity	SOD	
0.00	0.00	19.90	0.00		0.00	0.00	0.00	0.00	

**Crop Election Choice**

ARC Individual	ARC County	Price Loss Coverage
None	None	CORN

**DCP Crop Data**

Crop Name	Base Acres	CCC-505 CRP Reduction Acres	PLC Yield	HIP
Corn	19.89	0.00	136	
<b>TOTAL</b>	<b>19.89</b>	<b>0.00</b>		

**NOTES**

Tract Number : **4343**  
 Description : A4 20.0 ACRES N OF DITCH SW1/4-8-99-26  
 FSA Physical Location : IOWA/WINNEBAGO  
 ANSI Physical Location : IOWA/WINNEBAGO  
 BIA Unit Range Number :  
 HEL Status : HEL field on tract.Conservation system being actively applied  
 Wetland Status : Tract does not contain a wetland  
 WL Violations : None  
 Owners : CHAR-VER INC  
 Other Producers :  
 Recon ID : None

**Tract Land Data**

Farm Land	Cropland	DCP Cropland	WBP	EWP	WRP	GRP	Sugarcane
24.22	19.90	19.90	0.00	0.00	0.00	0.00	0.0
State Conservation	Other Conservation	Effective DCP Cropland	Double Cropped	CRP	MPL	DCP Ag. Rel Activity	SOD
0.00	0.00	19.90	0.00	0.00	0.00	0.00	0.00

Abbreviated 156 Farm Record

Tract 4343 Continued ...

DCP Crop Data

Crop Name	Base Acres	CCC-505 CRP Reduction Acres	PLC Yield
Corn	19.89	0.00	136
<b>TOTAL</b>	<b>19.89</b>	<b>0.00</b>	

NOTES

In accordance with Federal civil rights law and U.S. Department of Agriculture (USDA) civil rights regulations and policies, the USDA, its Agencies, offices, and employees, and institutions participating in or administering USDA programs are prohibited from discriminating based on race, color, national origin, religion, sex, gender identity (including gender expression), sexual orientation, disability, age, marital status, family/parental status, income derived from a public assistance program, political beliefs, or reprisal or retaliation for prior civil rights activity, in any program or activity conducted or funded by USDA (not all bases apply to all programs). Remedies and complaint filing deadlines vary by program or incident.

Persons with disabilities who require alternative means of communication for program information (e.g., Braille, large print, audiotape, American Sign Language, etc.) should contact the responsible Agency or USDA's TARGET Center at (202) 720-2600 (voice and TTY) or contact USDA through the Federal Relay Service at (800) 877-8339. Additionally, program information may be made available in languages other than English.

To file a program discrimination complaint, complete the USDA Program Discrimination Complaint Form, AD-3027, found online at [http://www.ascr.usda.gov/complaint\\_filing\\_cust.html](http://www.ascr.usda.gov/complaint_filing_cust.html) and at any USDA office or write a letter addressed to USDA and provide in the letter all of the information requested in the form. To request a copy of the complaint form, call (866) 632-9992. Submit your completed form or letter to USDA by: (1) mail U.S. Department of Agriculture Office of the Assistant Secretary for Civil Rights, 1400 Independence Avenue, SW Washington, D.C. 20250-9410; (2) fax: (202) 690-7442; or (3) e-mail: [program.intake@usda.gov](mailto:program.intake@usda.gov). USDA is an equal opportunity provider, employer, and lender.

# Soils Map

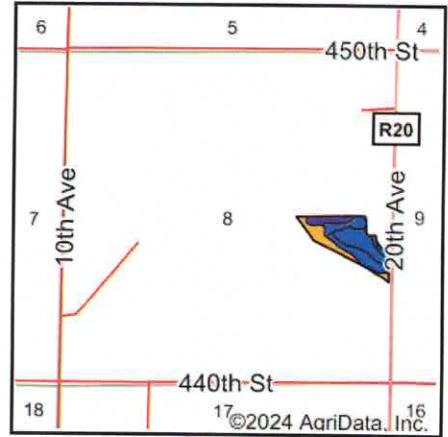
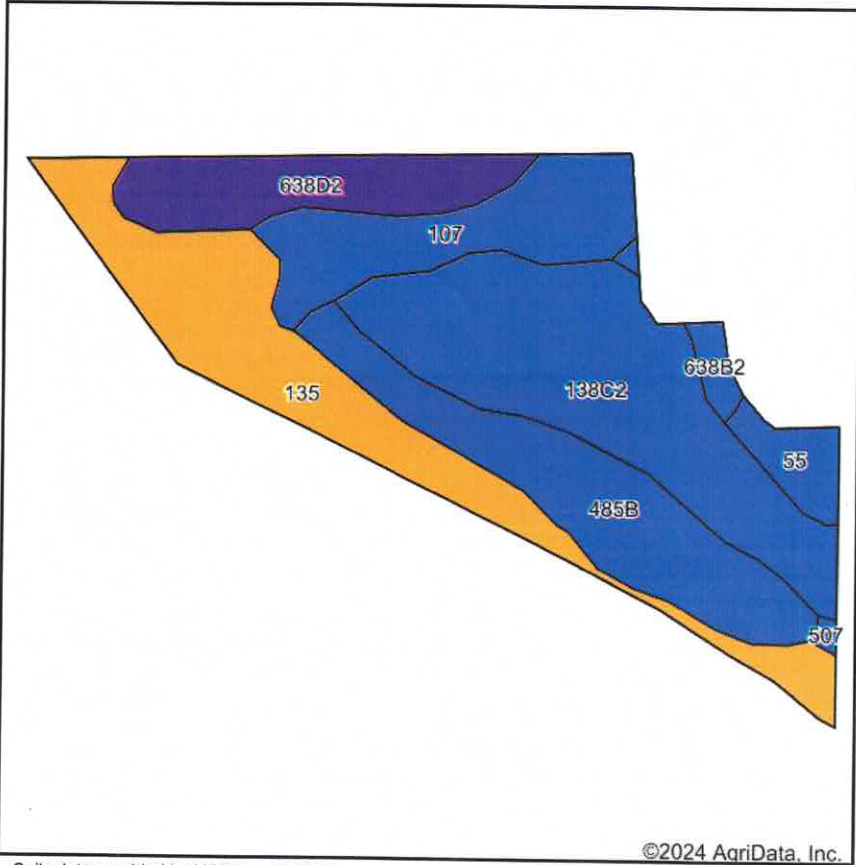





State: **Iowa**  
 County: **Winnebago**  
 Location: **8-99N-26W**  
 Township: **Buffalo**  
 Acres: **16.89**  
 Date: **2/5/2024**

Maps Provided By:  
  
 CUSTOMIZED ONLINE MAPPING  
 © AgriData, Inc. 2023 www.AgriDataInc.com

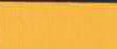

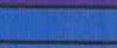
Area Symbol: IA189, Soil Area Version: 33

Code	Soil Description	Acres	Percent of field	CSR2 Legend	Non-Irr Class *c	CSR2**	CSR	*n NCCPI Soybeans	
138C2	Clarion loam, 6 to 10 percent slopes, moderately eroded	5.02	29.7%		Ille	83	63	70	
135	Coland clay loam, 0 to 2 percent slopes, occasionally flooded	3.90	23.1%		Ilw	76	78	83	
485B	Spillville loam, 2 to 5 percent slopes	3.04	18.0%		Ile	88	85	87	
107	Webster clay loam, 0 to 2 percent slopes	2.27	13.4%		Ilw	86	83	82	
638D2	Omsrud-Storden complex, 10 to 16 percent slopes, moderately eroded	1.84	10.9%		IVe	53	47	67	
55	Nicollet clay loam, 1 to 3 percent slopes	0.55	3.3%		Iw	89	88	81	
638B2	Clarion-Swanlake complex, 2 to 6 percent slopes	0.27	1.6%		Ile	85	71	82	
<b>Weighted Average</b>						<b>2.48</b>	<b>79.6</b>	<b>72.3</b>	<b>*n 77.9</b>

\*\*IA has updated the CSR values for each county to CSR2.

\*n: The aggregation method is "Weighted Average using all components"

\*\*IA has updated the CSR values for each county to CSR2.\*c: Using Capabilities Class Dominant Condition Aggregation Method



CONSERVATION PLAN

Client: MYERS, BRUCE E

Myers, Bruce E.

Assisted By: sharyl

LAND UNITS		PLANNED			APPLIED		PLANNED CONSERVATION TREATMENT
TRACT	FIELD	AMOUNT	MONTH	YEAR	AMOUNT	DATE	
t0075	1A, 2A	6.2Ac					Crop Conservation Reserve Program-Buffers Field(s) will be enrolled into the Conservation Reserve Program through the on-going continuous sign up period. Perennial vegetation will be established on all enrolled fields to reduce soil erosion, improve water quality, and enhance wildlife habitat.
t0075	1A	3.0ac	01	1999	3.0ac	05/15/1999	CONSERVATION COVER
	2A	3.2ac	01	1999	3.2ac	05/15/1999	Vegetative Filter Strip - This will be established with a minimum width of 66' and planted to Permanent Introduced Grasses and Legumes or Native Grasses. Refer to attached Job Sheet Agronomy 7.
t0075	1A	3.0ac	05	1998	3.0ac	05/15/1999	CONSERVATION COVER
	2A	3.2ac	05	1998	3.2ac	05/15/1999	Temporary Cover - Oats planted in CRP filterstrip. Permanent seeding will be planted next year.
t0075	1A	3.0ac	01	1998	3.0ac	05/15/1999	FILTER STRIP
	2A	3.2ac	01	1998	3.2ac	05/15/1999	A strip or area of vegetation for removing sediment, organic matter, and other pollutants from runoff and wastewater. To remove sediment and other pollutants from runoff or wastewater by filtration, deposition, infiltration, absorption, adsorption, decomposition, and volatilization, thereby reducing pollution and protecting the environment.
t0075	1A	3.0ac	01	1998	3.0ac	05/15/1999	Operation & Maintenance
	2A	3.2ac	01	1998	3.2ac	05/15/1999	All practices will have to be maintained for the life of this contract.
t0075	1A	3.0ac	01	1998	3.0ac	05/15/1999	USE EXCLUSION
	2A	3.2ac	01	1998	3.2ac	05/15/1999	All contracted acres must be excluded from domestic livestock grazing for the duration of the contract.
t0075	1A	3.0ac	01	1998	3.0ac	05/15/1999	WILDLIFE UPLAND HABITAT MANAGEMENT
	2A	3.2ac	01	1998	3.2ac	05/15/1999	Creating, maintaining, or enhancing areas, including wetland, for food and cover for upland wildlife. To create, maintain, or enhance habitat suitable for sustaining desired kinds of upland wildlife.
t0075	1w	0.1Ac					Wildlife This field(s) is to be used as a wildlife area. Leaving this field(s) and odd areas in a natural condition will provide good wildlife habitat. To provide quality wildlife habitat, livestock need to be excluded from this field(s). For a detailed wildlife management plan, contact your local Soil and Water Conservation District Office or DNR Wildlife

CONSERVATION PLAN

Client: MYERS, BRUCE E

Myers, Bruce E.

Assisted By: sharyl



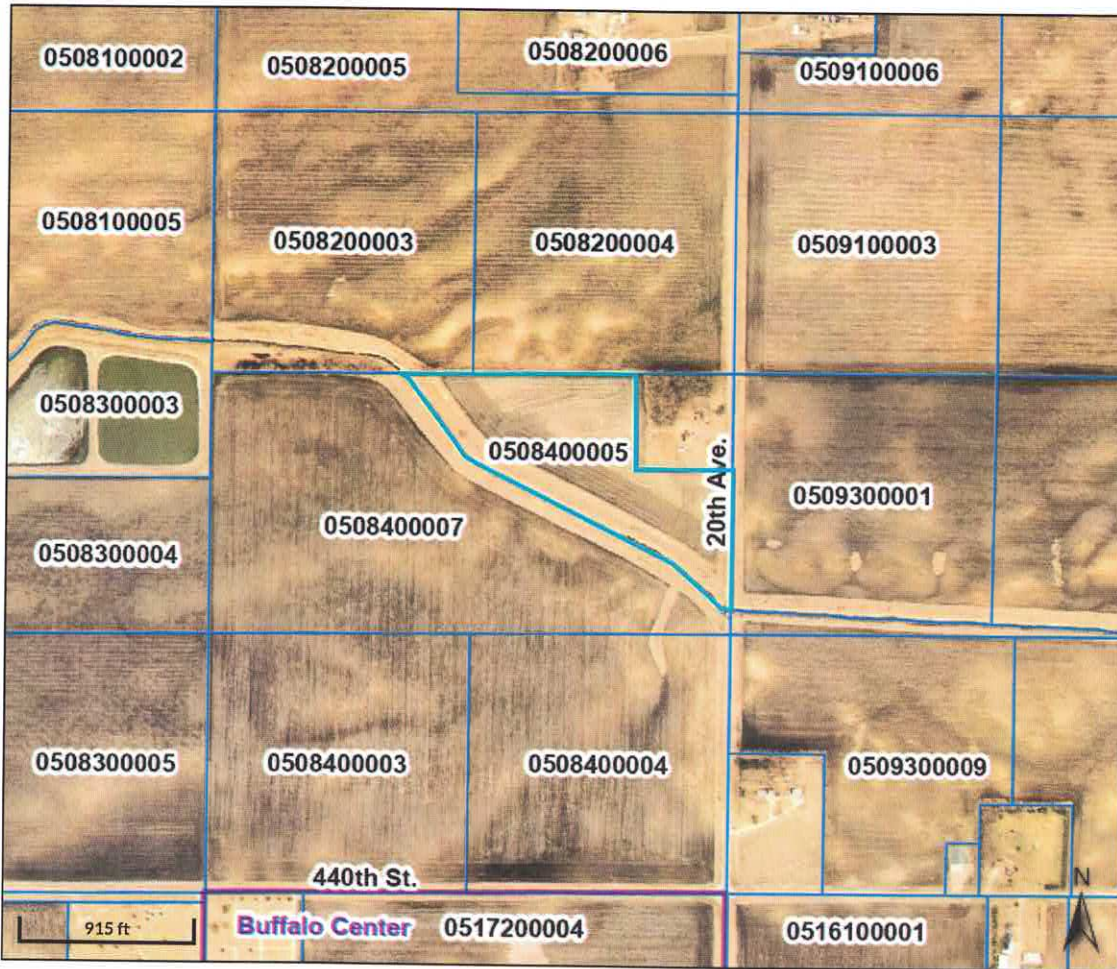

LAND UNITS		PLANNED			APPLIED		PLANNED CONSERVATION TREATMENT	
TRACT	FIELD	AMOUNT	MONTH	YEAR	AMOUNT	DATE		
							Biologist.	
t0075	1w	285.0ft	05	2000	285.0ft	05/09/2000	<p>WINDBREAK/SHELTERBELT ESTABLISHMENT</p> <p>A belt of trees or shrub established next to a farmstead or feedlot. To protect soil resources, conserve energy, control snow deposition, prevent wind damage to farmsteads, provide shelter for livestock, beautify an area, or improve an area for wildlife.</p>	
t0075	1	9.9ac					<p>CROP</p> <p>A CROP ROTATION of corn corn soybeans will be used on these fields. The following tillage system will be used: Soybean stubble and corn stalks are tilled leaving at least 20% of the ground covered by residue after planting corn. Corn stalks are tilled leaving at least 20% of the ground covered by residue after planting soybeans. GRASSED WATERWAYS are required as shown on the conservation plan map.</p>	
t0075	1	HEL*	9.9ac	05	1990	9.9ac	05/15/1991	<p>CONSERVATION CROP ROTATION</p> <p>THE PLANNED ROTATION IS CORN/OAT/MEADOW/MEADOW, SCHEDULED TO BEGIN IN 1992.</p>
t0075	1	HEL*	0.5ac	05	1988	0.5ac	05/14/1988	GRASSED WATERWAY
t0075	1	HEL*	9.9ac	05	1992	9.9ac	05/18/1992	RESIDUE MANAGEMENT, SEASONAL



**Overview**



**Legend**

-  Corporate Limits
-  PLS Townships
- Parcels**
-  <blank>
-  Roads
-  Private Roads

Parcel ID	050840005	Alternate ID	n/a	Owner Address	CHAR VER INC
Sec/Twp/Rng	n/a	Class	A		12530 DORCHESTER TRL
Property Address		Acreage	17.62		ST PAUL, MN 55124-5240
District	BUNI				
Brief Tax Description	08 99 26 PART OF N1/2 SE 1/4 8 99 26 LYING N & E OF DD EX THE E 499.2' OF N 480'				
	<i>(Note: Not to be used on legal documents)</i>				

Date created: 2/19/2024

Last Data Uploaded: 2/19/2024 2:12:58 AM

Developed by  Schneider  
GEOSPATIAL