

Soils Map

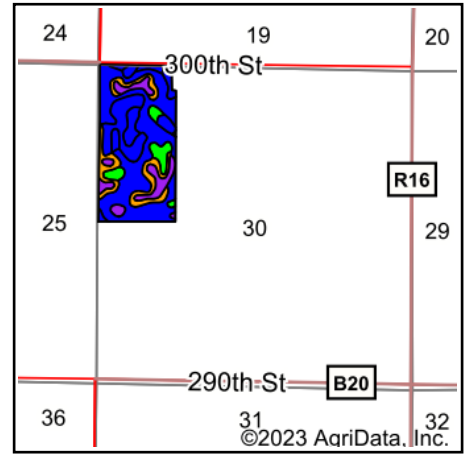

Soils data provided by USDA and NRCS.









State: **Iowa**
 County: **Hancock**
 Location: **30-97N-26W**
 Township: **Bingham**
 Acres: **75.09**
 Date: **12/19/2023**

Maps Provided By:

 CUSTOMIZED ONLINE MAPPING
 © AgriData, Inc. 2023 www.AgriDataInc.com

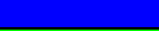

Area Symbol: IA081, Soil Area Version: 34

Code	Soil Description	Acres	Percent of field	CSR2 Legend	Non-Irr Class *c	CSR2**	CSR	*n NCCPI Soybeans	
507	Canisteo clay loam, 0 to 2 percent slopes	34.91	46.5%		IIw	84	78	81	
138B	Clarion loam, 2 to 6 percent slopes	12.41	16.5%		Ile	89	80	83	
95	Harps clay loam, 0 to 2 percent slopes	9.77	13.0%		IIw	72	62	82	
6	Okoboji silty clay loam, 0 to 1 percent slopes	7.41	9.9%		IIIw	59	57	74	
55	Nicollet clay loam, 1 to 3 percent slopes	5.50	7.3%		Iw	89	88	81	
655	Crippin loam, 1 to 3 percent slopes	5.09	6.8%		Ie	91	83	86	
Weighted Average						1.96	81.6	75.2	*n 81.1

**IA has updated the CSR values for each county to CSR2.

*n: The aggregation method is "Weighted Average using all components"

*c: Using Capabilities Class Dominant Condition Aggregation Method

Soils data provided by USDA and NRCS.